

Redmi Buds Essential User Manual	01
Redmi Buds Essential 取扱説明書	15
Redmi Buds Essential 사용 설명서	29
Redmi Buds Essential مديخت سم ليلد	42
Panduan Pengguna Redmi Buds Essential	56
Redmi Buds Essential Kullanım Kılavuzu	72



Redmi

Read this manual carefully before use, and retain it for future reference.

Illustrations of product, accessories, and user interface in the user manual are for reference purposes only. Actual product and functions may vary due to product enhancements.

Product Overview

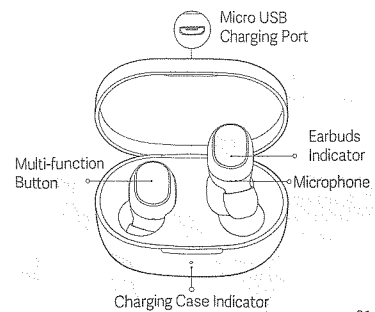

First-time Use

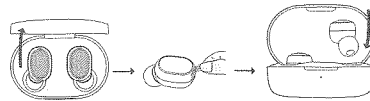

1. Open the lid and take out earbuds.
2. Remove the protective film.
3. Put both earbuds back into the charging case for charging, and then take them out for pairing.

Wearing



- Gently place the earbud into your ear canal, then adjust it to a comfortable position.
- During calls, make sure to point the primary microphone towards your mouth for clearer calls.

Note: The M-size ear tips are preinstalled. If feeling uncomfortable, please change to size L or S for a better fit.

02

Charging

Charging the earbuds

When the earbuds are placed in the charging case, they will automatically start charging. The earbuds indicator remains white while charging, and turns off when fully charged.

Note: After using the earbuds, place them back into the charging case. This will extend their service life and helps to avoid losing or misplacing them.

Charging the charging case

Connect the charging cable to charge both the earbuds and the charging case. The charging case indicator remains red while charging, and turns off when fully charged.

Turning On

Make sure that the charging case has sufficient charge and that the earbuds are in it. Open the lid and take out the earbuds, which will turn on automatically.

03

Turning Off

Make sure the charging case is not out of battery, place both earbuds back into the charging case, the indicator of left/right earbuds turns white, the earbuds will automatically disconnect and start charging and turn off.

When paired and out of the charging case, if the earbuds are not connected to the device within 10 minutes, they will turn off automatically.

Connection

First time connection

Open the lid and take out the earbuds. Wait for the indicator of left/right earbuds to slowly blink white, indicating that the earbuds are awaiting connection. Make sure that the Bluetooth function on your phone is enabled and search for "Redmi Buds Essential" to connect the earbuds.

Note: If the earbuds cannot be connected, place them back into the charging case and repeat the above operation.

Connecting to other devices

To connect to a new device, unpair the earbuds on the connected phone or reset the earbuds.

Automatic connection

When the earbuds are in the charging case, open the lid and take out the earbuds, which will automatically connect to the most recently used Bluetooth device. If the earbuds are not connected to any device, they will automatically enter the awaiting connection mode.

Disconnected

When your device's Bluetooth is disabled or if the earbuds are out of wireless range, the earbuds will automatically enter awaiting connection mode. If they are not connected to any device within 10 minutes, the earbuds will turn off automatically.

Switch between single/dual bud mode

When both earbuds are connected successfully, they are in dual-bud mode. If place one of the buds back into the charging case and close its lid, the other bud will automatically enter the single-bud mode. When removing the second bud from the charging case, the dual-bud mode will automatically be restored again.

Reset Earbuds

If the earbuds do not work properly, reset them as follows: Make sure that the charging case has sufficient charge, open the lid and place both earbuds into the case. Press and hold the multi-function button on the left and right earbuds for at least 5 seconds, then release the button. The indicator on the left and right earbuds will rapidly blink white 3 times, indicating that the earbuds have been reset successfully (the connection history between the left and right earbuds and between the earbuds and the phone has been cleared).

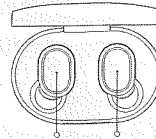

Press and hold for 5 seconds

Function Overview

Note: Once the weather is cold outdoors and your hands become dry, the earbuds may not function when touching them.

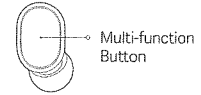

During calls

Single tap: Answer a call

Double tap: Decline or end a call

Play/Pause Music

Single tap: Pause or play

Play next track

When playing audio, double tap the earbud's multi-function button to play the next track

Low Latency mode

While the earbuds are connected to a phone (not during a call), press and hold the multi-function button on the left and right earbuds for 1.5 seconds, then release the button, to turn Low Latency mode on/off.

Wake up the phone's voice assistant

While wearing the earbuds (not during a call), press the multi-function button three times to wake up the voice assistant.*

*The device connected to the earbuds needs to support the voice assistant feature.

Answer a Second Call

Tap the multi-function button of left/right earbuds to put the ongoing call on hold and answer the incoming call. After answering the second call, tap the left/right earbud's multi-function button to switch between two calls; double tap the left/right earbud's multi-function button to hang up the current call and answer the call on hold.

Specifications

Name: Wireless Earphones

Model: M2222E1

Frequency Band: 2402-2480 MHz

Max RF Output Power: < 20 mW

Storage Temperature: 0 °C to 45 °C

Operating Temperature: 0 °C to 45 °C

Earbuds

Input: 5 V \Rightarrow 100 mA

Wireless Range: 10m (in an obstacle-free environment)

Wireless Connectivity: Bluetooth® 5.2

Charging Case

Model: M2222E1

Battery Capacity: 300mAh

Input: 5 V \Rightarrow 500 mA

Output: 5 V \Rightarrow 150 mA

Important Safety Information

- The product has a built-in battery that can not be removed or replaced. To avoid damage to the battery or the product, do not disassemble or modify the battery by yourself. The battery can only be replaced by the authorized service providers and must be replaced with the same type. Replacement of a battery with an incorrect type may defeat a safeguard (such as catching fire, explosion and leakage of corrosive electrolyte). Do not dispose of used batteries with household waste. Disposal of this product and the used batteries shall comply with local laws and regulations.
- Do not attempt to disassemble, repair or modify the product, as this may cause fire or even completely damage the product.
- Keep the product's indicator away from the eyes of children and animals while the product is in use.
- Do not disassemble, puncture or crush the product nor expose it to fire.
- Please stop using the product immediately and seek medical assistance if the contact area on your skin shows signs of redness or swelling.
-  To prevent possible hearing loss, do not use high volume for long periods of time.

10

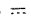
- This product is not a toy and may contain small parts. Please keep them out of the reach of children.
- Disposal of a battery into fire or a hot oven or water or other liquids or mechanically crushing or cutting of a battery, that can result in an explosion.
- Leaving a battery in an extremely high temperature surrounding environment that can result in an explosion or the leakage of flammable liquid or gas.
- A battery subjected to extremely low air pressure that may result in an explosion or the leakage of flammable liquid or gas.
- Product information and certification marks are located in the Charging Case.
-  The symbol indicates DC voltage.

EU DECLARATION OF CONFORMITY

Hereby, Dongguan Yingsheng Electronic Technology Co., Ltd. declares that the radio equipment type M2222E1 is in compliance with Directive 2014/53/EU. The full text of the EU declaration of conformity is available at the following internet address:
<http://www.mi.com/global/service/support/declaration.html>

11



WEEE Information

All products bearing this symbol are waste electrical and electronic equipment (WEEE as in directive 2012/19/EU) which should not be mixed with unsorted household waste. Instead, you should protect human health and the environment by handing over your waste equipment to a designated collection point for the recycling of waste electrical and electronic equipment, appointed by the government or local authorities. Correct disposal and recycling will help prevent potential negative consequences to the environment and human health. Please contact the installer or local authorities for more information about the location as well as terms and conditions of such collection points.

Warranty Notice

As a Xiaomi consumer, you benefit under certain conditions from additional warranties. Xiaomi offers specific consumer warranty benefits which are in addition to, and not instead of, any legal warranties provided by your national consumer law. The

duration and conditions related to the legal warranties are provided by respective local laws. For more information about the consumer warranty benefits, please refer to Xiaomi's official website <https://www.mi.com/en/service/warranty/>. Except as prohibited by laws or otherwise promised by Xiaomi, the after-sales services shall be limited to the country or region of the original purchase. Under the consumer warranty, to the fullest extent permitted by law, Xiaomi will, at its discretion, repair, replace or refund your product. Normal wear and tear, force majeure, abuse or damage caused by the user's negligence or fault are not warranted. The contact person for the after-sale service may be any person in Xiaomi's authorized service network, Xiaomi's authorized distributors or the final vendor who sold the products to you. If in doubt please contact the relevant person as Xiaomi may identify. Products which were not duly imported and/or were not duly manufactured by Xiaomi and/or were not duly acquired from Xiaomi or a Xiaomi's official seller are not covered by the present warranties. As per applicable law you may benefit from warranties from the non-official retailer who sold the product. Therefore, Xiaomi invites you to contact the retailer from whom you purchased the product.

The Bluetooth® word mark and logos are registered trademarks owned by Bluetooth SIG, Inc. and any use of such marks by Xiaomi Inc. is under license. Other trademarks and trade names are those of their respective owners.

Complies With
IMDA Standards
DB106135

82377/SDPPI/2022
9003



Manufactured for: Xiaomi Communications Co., Ltd.
Manufactured by:
Dongguan Yingsheng Electronic Technology Co., Ltd.
(a Mi Ecosystem company)
Address: Suite 204, 4th Block, No. 86 Hongtu Road,
Nancheng District, Dongguan, Guangdong, China.

For further information, please go to www.mi.com
User Manual Version: V1.0

ご使用前に本取扱説明書をよくお読みください。また、いつでも参照できるように保管しておいてください。
取扱説明書に記載されている製品の図案、周辺機器、ユーザーインターフェイスは参照用です。実際の製品および機能は製品に実施される強化によって異なる場合があります。

製品紹介

